



**MOVE INN ESTATES**  
MAKING THE RIGHT MOVE



**Northcote Avenue**  
Southall, UB1 2BA  
£6,000 Per Month



# Floor Plan

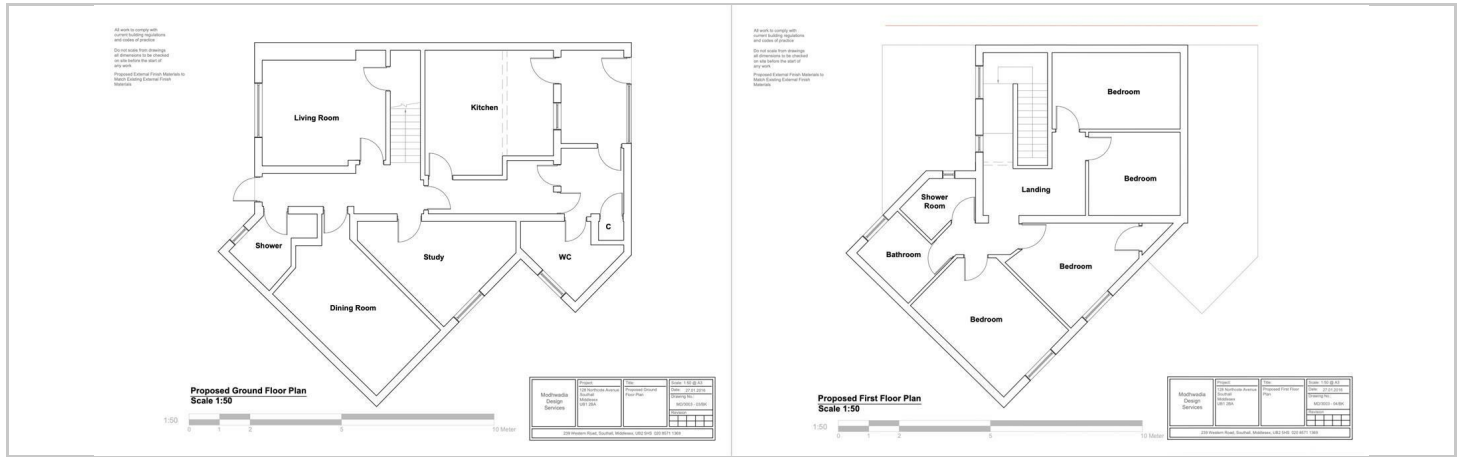

# Area Map

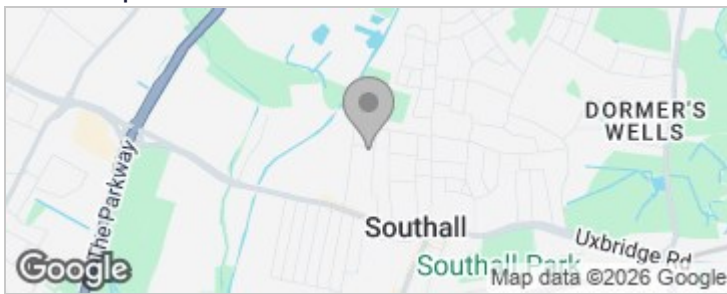

# Energy Efficiency Graph

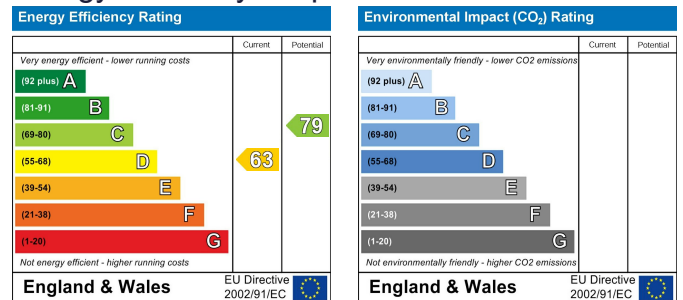

## Viewing

Please contact our Move Inn Estates - Sales Office on 0208 574 4966 if you wish to arrange a viewing appointment for this property or require further information.

This substantial HMO property, located on Northfield Avenue in Southall, offers a strategic accommodation solution for companies seeking to house multiple staff members under one roof. With a licensed capacity for up to 12 occupants, this property is ideal for businesses requiring flexible, cost-effective housing arrangements.

## Property Features:

- \* 7 Bedrooms: Spacious rooms suitable for single or shared occupancy.
- \* 4 Bathrooms: Ensuring convenience and comfort for all residents.
- \* 2 Fully Equipped Kitchens: Designed to handle multiple users simultaneously.
- \* Licensed for Up to 12 Occupants: Compliant with local regulations, offering flexibility for various accommodation needs.

## Location & Transport Links:

- \* Southall Railway Station: Provides direct services to London Paddington, Heathrow Airport, and Reading, facilitating easy access for commuting staff.
- \* Osterley Tube Station (Piccadilly Line): Approximately 1.5 miles away, offering direct connections to Central London.
- \* Bus Services: Frequent routes connecting Southall with neighbouring areas and Heathrow Airport.

## Local Amenities:

- \* Shopping & Dining: The Broadway in Southall is renowned for its vibrant mix of shops, restaurants, and cultural establishments, offering a variety of dining and shopping options.
- \* Parks & Recreation: Nearby Southall Park provides green space for relaxation and outdoor activities.

## Ideal For:

- \* Companies seeking to house multiple staff members in close proximity to transport links and local amenities.
- \* Organisations requiring flexible accommodation solutions for short or long-term stays.

This property presents a unique opportunity for businesses to secure a well-located, licensed HMO in Southall, catering to the accommodation needs of multiple occupants.



These particulars, whilst believed to be accurate are set out as a general outline only for guidance and do not constitute any part of an offer or contract. Intending purchasers should not rely on them as statements of representation of fact, but must satisfy themselves by inspection or otherwise as to their accuracy. No person in this firm's employment has the authority to make or give any representation or warranty in respect of the property.

46 Vicarage Farm Road, Hounslow, Middlesex, TW5 0AB

Tel: 0208 574 4966 Email: [info@moveinnestates.co.uk](mailto:info@moveinnestates.co.uk) [www.moveinnestates.co.uk](http://www.moveinnestates.co.uk)